



Peters

REAL ESTATE



30 Melbee Street Rutherford NSW

3 1 2

Perfectly positioned behind established gardens and charming facade, handsome proportions retain their magnificent originality whilst being conveniently located less than 1km to local schools, shops, sporting fields and transport.

In original condition, the character-filled interiors offer superb scope for updating with generous proportions and a superior floor plan providing the basis for you to make your mark on this charming home whilst old school charm presents high ceilings, picture rails and ornate plasterwork throughout.

With three large bedrooms all accommodating built-in robes, the home is suitable for a number of family

[For full version visit the website](#)

Type : House
Price : \$595,000 - \$615,000
Land Size : 614 sqm
View : <https://www.petersrealestate.com.au/sale/nsw/hunter-valley-lower/rutherford/residential/house/8169683>



Jaide Van Wyck
4933 7855

<https://www.petersrealestate.com.au>

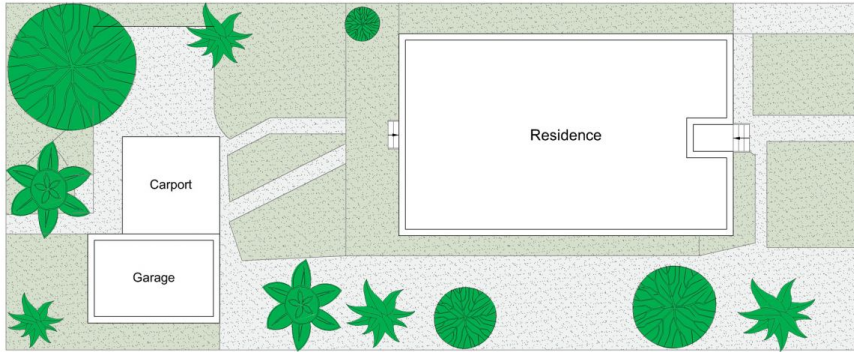
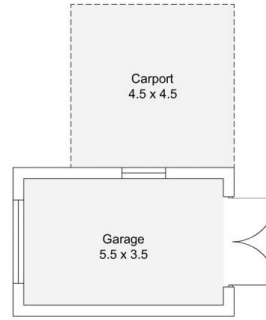

30 Melbee St,
Rutherford



Illustration for identification purposes only, measurements are approximate only and not to scale